



Clip-it

Online Shop

EN

CLIP IT! Instructions for use.

When used with a MAM or other button soother, press the transparent ring (which is attached to the flexible loop) over the button of the soother (Diagram A). When used with a soother with handle, attach the flexible loop directly to the handle of the soother (Diagram B). The flexible loop securely holds not only soothers but also teethingers, small toys and much more (Diagram C). The clip fastener is opened by moving the slider towards the leash and closed by clicking the slider towards the rounded end (Diagram D). The clip should only be attached to garments. The clip fastener should always be **stored and cleaned in the open position** to avoid the clip spring losing its strength. Do not store in the closed position. Regularly clean the clip and the flexible ring with warm water and mild cleaning agent. Rinse thoroughly. **DO NOT BOIL**, steam or microwave sterilise. Do not use solvents or abrasive cleaning agents as these could damage the product. The length controller can be used to lengthen or shorten the clip leash by simply pulling it up or down along the leash. Do not worry if your child's arm, wrist or finger gets stuck in the loop of the strap. Remove as gently as possible. The textile loop will not cause any harm.

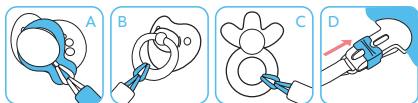

For your child's safety

WARNING!

Before each use check the soother holder carefully. Throw away at the first sign of damage or weakness.

Never lengthen the soother holder!

Never attach to cords, ribbons, laces or loose parts of clothing. The child can be strangled.

The clip should not be used when the baby is sleeping or in bed, crib or cot.

Ensure both ends of the clip are fastened before leaving your child unattended.

The clip should not be used as a teether or toy.

The clip meets the requirements of EN 12586:2025.